



June 27, 2007

Directions to Shop



Building



Road



Canal



RR Tracks



Tree Farms



Town

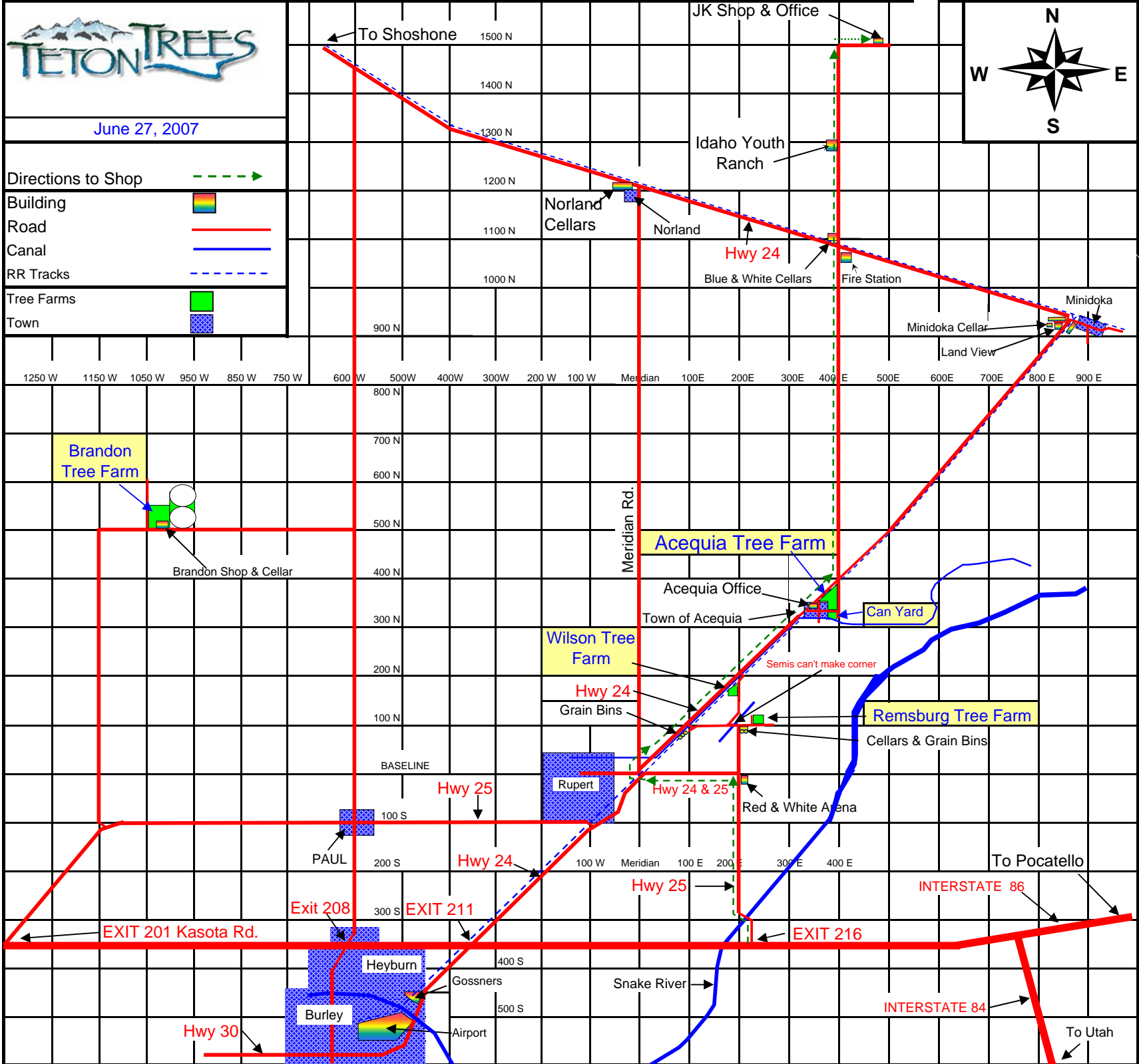
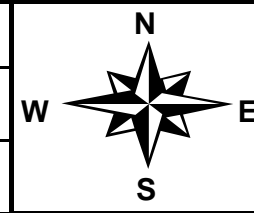

To Shoshone 1500 N

1400 N

1300 N

1200 N

1100 N

1000 N

900 N

1250 W

1150 W

1050 W

950 W

850 W

750 W

800 N

700 N

600 N

500 N

400 N

300 N

200 N

100 N

BASELINE

100 S

200 S

300 S

400 S

500 S

Meridian Rd.

Meridian

Snake River

JK Shop & Office

Idaho Youth Ranch

Norland Cellars

Norland

Hwy 24

Blue & White Cellars

Fire Station

Minidoka

Minidoka Cellar

Land View

Brandon Tree Farm

Brandon Shop & Cellar

Acequia Tree Farm

Acequia Office

Town of Acequia

Can Yard

Wilson Tree Farm

Hwy 24

Grain Bins

Semis can't make corner

Remsburg Tree Farm

Cellars & Grain Bins

Rupert

Hwy 25

Hwy 24 & 25

Red & White Arena

PAUL

Hwy 24

To Pocatello

EXIT 201 Kasota Rd.

Exit 208

EXIT 211

Hwy 25

EXIT 216

INTERSTATE 86

Heyburn

Gossners

Airport

INTERSTATE 84

Hwy 30

Burley

To Utah